

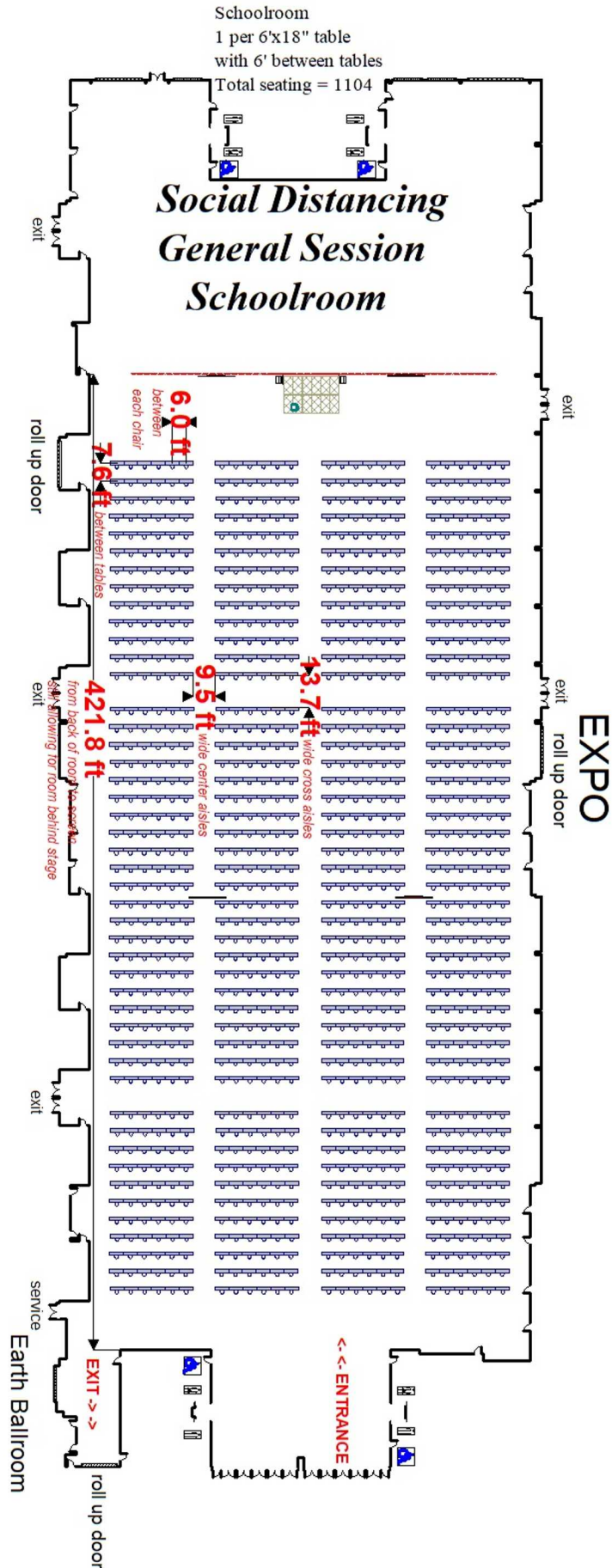

Roadmap for group up to 1000 attendees practicing social distancing:

- Pre-Function space with one way entry /exit lanes with signage in the form of floor clings and poster boards.
- Multiple and/or separate registration areas to increase social distancing protocols.
- Stagger groups to avoid queue lines or unnecessary bottlenecks:
 - Staggering the arrivals of attendees to events to reduce bottlenecks at hotel elevators and get to their seats in an orderly fashion that preserves the distance limits.
 - Arrivals may be staggered by alphabet or by guestroom floors in 10-20 minute intervals. Example A-F, G-L, M-S, T-Z.
 - Flow of guests may be diverted with multiple entry points (see attached diagrams).
 - Extended breaks and catered meals with staggered release by row in opposite directions of the center aisle or staggered dining times.
 - Groups staggered released at conclusion of events to alleviate hotel elevator pressure. Consider ending with breakouts with differing times for conclusion.
- Suggest General Session set be used for catered meals
- For server attended buffets or action stations multiple locations set to maintaining social distancing guidelines.
- For plated meals attendees to be provided color coded meal cards to expedite entrée chosen.
- Breakouts – set for social distancing, if needed guests could also attend breakouts virtually from their guestrooms as a hybrid event.
- When group returns to General Session room for dinner the existing stage may be utilized for awards presentation, speakers and/or entertainment.
- Attached diagrams represent sample attendee flow, general session set for 1000 at 1 per 6' and sample catered meal set up.



Close Up View of Schoolroom Seating:

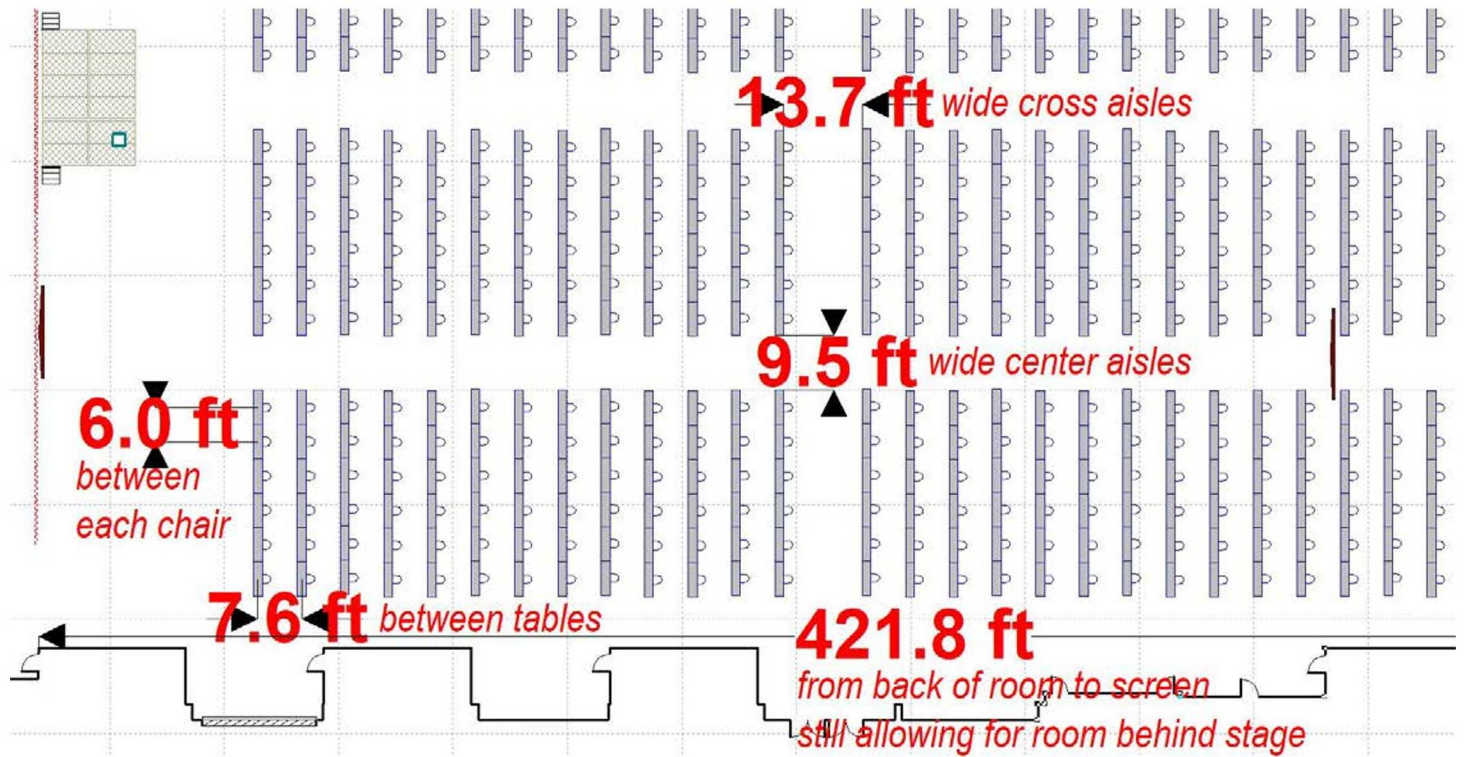

SOCIAL DISTANCE DINING
Rounds with 3 per 6' table for 570 ppl

Uncas Ballroom

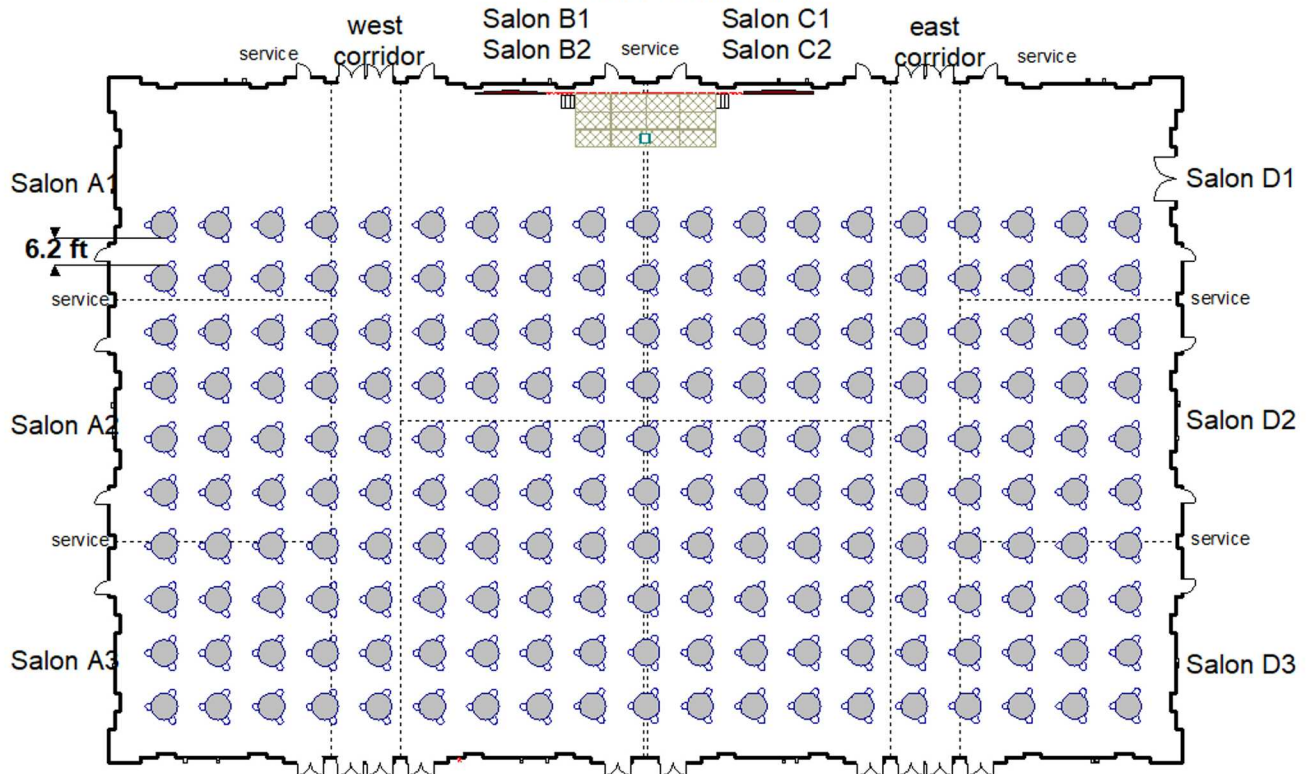

EARTH CONVENTION CENTER: Entry & Exit Points

 = Diversion Point

Arrows depict multiple entry and exit points for attendees arriving and departing general session space.

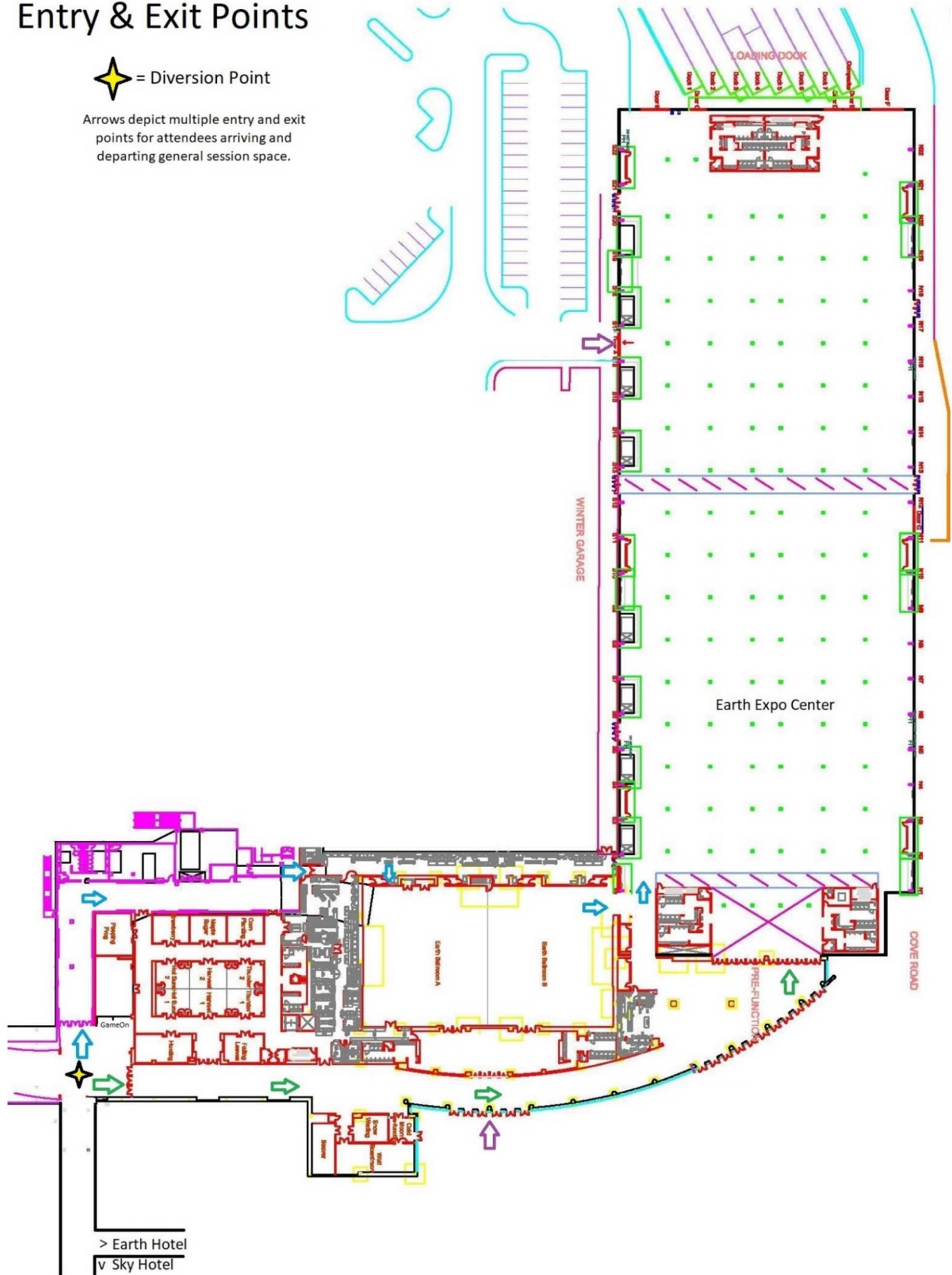

Sky Convention Center: Entry & Exit Points

Arrows depict multiple entry and exit points
for attendees arriving and departing
general session space from two levels.

 = Diversion Point

